

1

2

REVISION HISTORY

REV	DESCRIPTION	DATE	APPROVED
01	Parts List updated	02-06-2022	LJ
02	Titel updated	28-06-2022	LJ

A

A

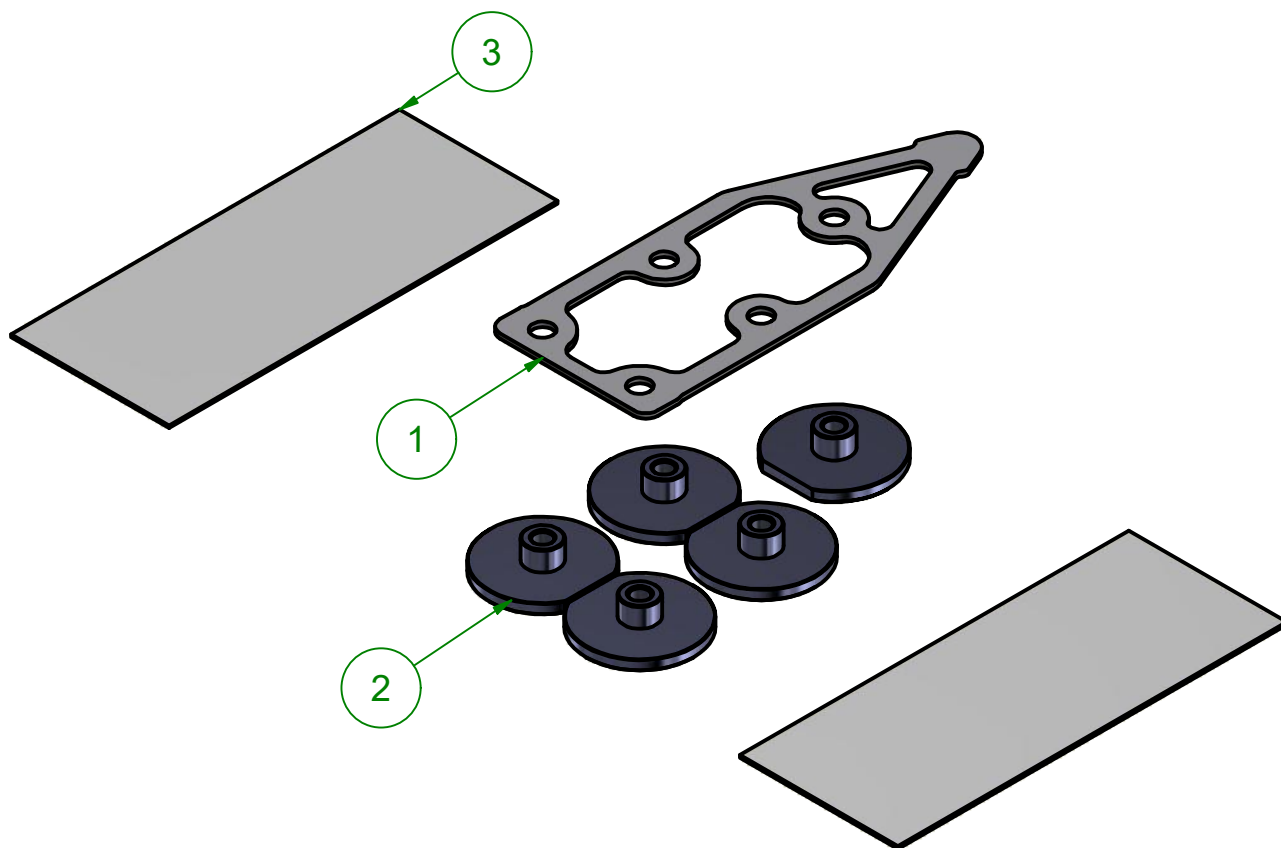

B

B

C

C

Item	Qty	Drawing no	Description	Rev no
1	1	500671	Spacer 2 mm	02
2	5	502152	Nut Special M8	01
3	2	501910	Spacer PVC 160x65x1 mm	00



Dimension

Material:

List of spare parts:

Weight: 0 kg

Chamfer:

Surface treatment:

Measures without tol.: DS/EN 22768-M

Latest correction:

Replaced by:

Replaces:

DAHL

ENGINEERING

Date: 20-06-2018

Issuer: JH

Karma Mid Lectus
Karma Morgan M Versus
Karma Morgan M Sling

Title:

Adaptationssæt til Dahl Docking Station

Adaptionsset für Dahl Docking Station

Adaptation Kit for Dahl Docking Station

Scale:

Drawing no.:

Rev no.:

503339

02