

1			2	
Item	Qty	Drawing no	Description	Rev no
1	5	501757	Nut for 4 mm.	01

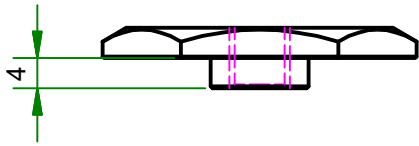
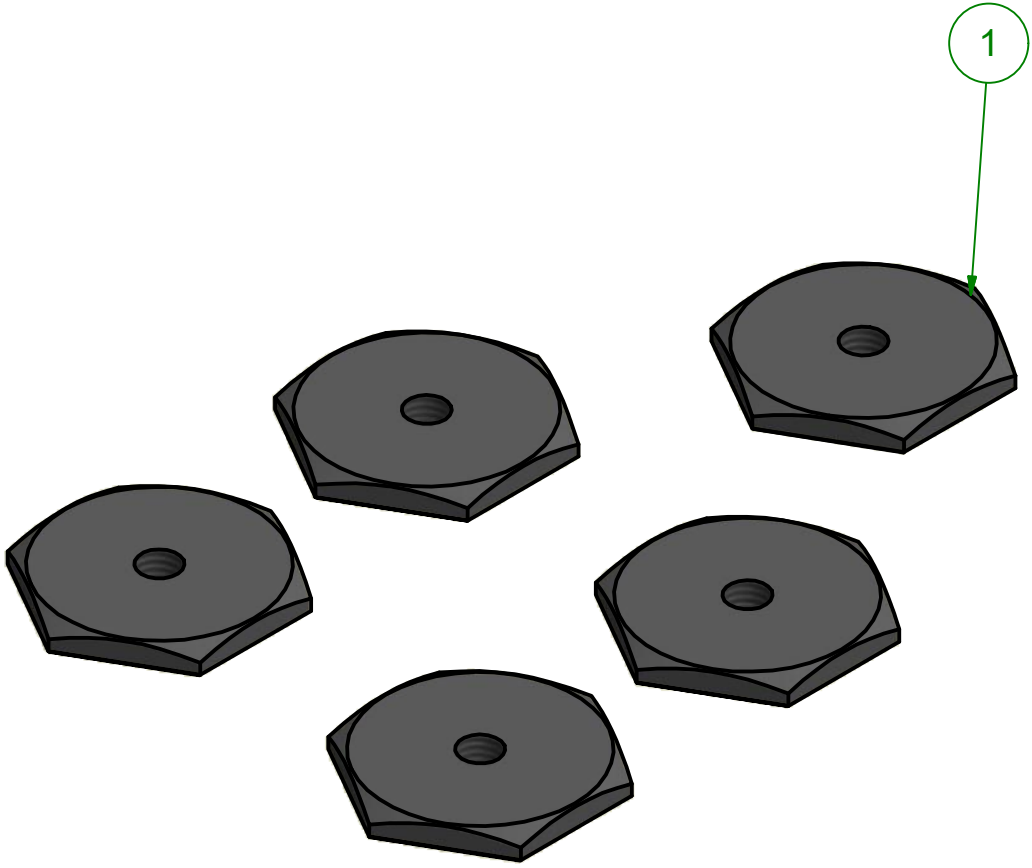

COPYRIGHT © THIS DRAWING REMAINS THE PROPERTY OF DAHL ENGINEERING
 Copying, submitting to third parties or use for any purpose other than that originally intended is prohibited without previous written consent of DAHL ENGINEERING

A
 B
 C

A
 B
 C

✓	Dimension	Material:	List of spare parts:	Weight: 0 kg
	Chamfer:	Surface treatment:	Measures without tol.: DS/EN 22768-M	
Latest correction:			Replaced by:	Replaces:

	Date:	03-06-2014	For: ROLTEC MOVED	
	Issuer:	JH		
Title: Adaptation kit for DAHL Docking Station 4mm. Adaptionssæt für DAHL Docking Station 4mm. Adaptionssæt til DAHL Docking Station 4mm.		Scale:	Drawing no:	Rev no.:
			501819	00